

GE Silicone Weathersealants

Information on GE Weatherproofing Sealants

GE SCS2000 - SilPruf*

- **Dual-purpose** – Weathersealing and structural glazing
- High strength, elasticity and tear properties
- Meets ASTM C920 Type S, Grade NS, Class 50
- Carries SWRI validation
- Meets ASTM C1184 Structural Silicone spec and
- Multiple colors + custom
- Successfully used in blast, seismic and hurricane impact tests/designs
- Structural sealant on world's first significant 4-sided SSG facade without safety mechanisms
- 43-year track record, since 1973
- Neutral cure 1-part silicone
- Project Warranty available
- ASTM C920 Sealants spec

GE SCS2700 - SilPruf* LM

- **Low-modulus** - weathersealant with high elasticity
- Soft flexible rubber places low stress on bond line
- Meets ASTM C920 Type S, Grade NS, Class 100/50
- Passes ASTM C719 movement test @ +100/-50%
- Best for EIFS and weaker substrates
- Candidate for use in seismic and similar high joint movement designs
- 17-year track record, since 1999
- Neutral cure 1-part silicone
- Project Warranty available
- Carries SWRI validation
- Multiple colors + custom

GE SCS2900 - UltraPruf* II

- **Matte-finish** – weathersealant
- Meets ISO 11600, Type F & G, Class 25LM
- Meets ASTM C920 Type S, Grade NS, Class 50
- Multiple colors + custom
- 36-year track record, since 1980
- Neutral cure 1-part silicone
- Project Warranty available

GE SCS9000 - SilPruf* NB

- **Non-staining** – weathersealant with reduced dirt attraction
- Neutral cure 1-part silicone
- Project Warranty available
- Meets ASTM C920 Type S, Grade NS, Class 50
- Carries SWRI validation
- Best candidate for sealing to natural stones
- No limitations on stone type:
 - OK for Sandstones
 - OK for Limestones
 - OK for Granites
 - OK for Marbles
- 17-year track record, since 1999
- Multiple colors + custom

GE Silicone Weather Seal (SWS)

- **High Elasticity** – neutral cure 1-part silicone
- Meets ASTM C920 Type S, Grade NS, Class 50
- Carries SWRI validation
- Soft flexible rubber places low stress on bond line
- Multiple colors available
- Suitable for both a variety of substrate materials



GE SilShield* 2400

- Silicone elastomeric architectural wall coating
- 17-year track record, since 1999
- 2-coat system; never needs primer
- 10mil DFT for 10 year warranty
- Coating is vapor permeable and is easily cleaned
- Typical 1-2 hour re-coat time
- Unlike acrylic coatings:
 - doesn't chalk or bloom
 - Color matched to any color
 - 100% Silicone durability for long-life
- Carries SWRi validation; resists wind-driven rain
- Meets ASTM C1305 Crack Bridging Ability: Results; no cracking

○ **AVAILABLE IN CLEAR**

GE Optic* 2401 →



GE UltraSpan* US1100

- **Silicone weatherstrip** with high elasticity (Ult_E 650%)
- Soft flexible rubber places low stress on bond line
- Meets ASTM C1523, Class 200, Tear Class PT
- Passes ASTM C719 movement test @ +200/-75%
- Ideal for EIFS and weaker substrates
- Ideal for remedial work to overhaul existing failed joint seals
- Candidate for use in seismic and similar high joint movement designs
- 21-year track record, since 1995
- 100% silicone rubber
- Project Warranty available
- Carries SWRi validation
- Multiple widths, colors + custom

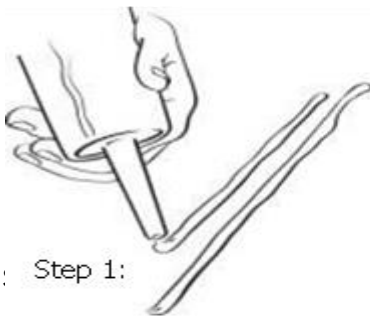

Step 1:

Apply Sealant

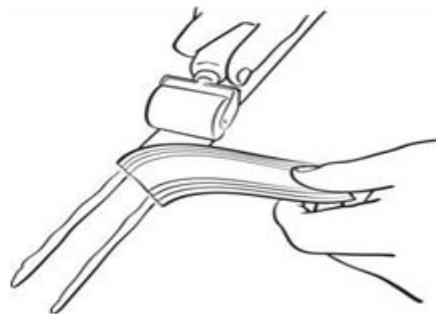

Step 2: Position UltraSpan*



**UltraSpan* 3D custom
molded and extruded
solutions are available**

